



London
Stock Exchange

Media and Business Complex

CONFERENCES AND EVENTS IN THE VIBRANT HEART OF THE CITY





Media & Business Complex floor plan

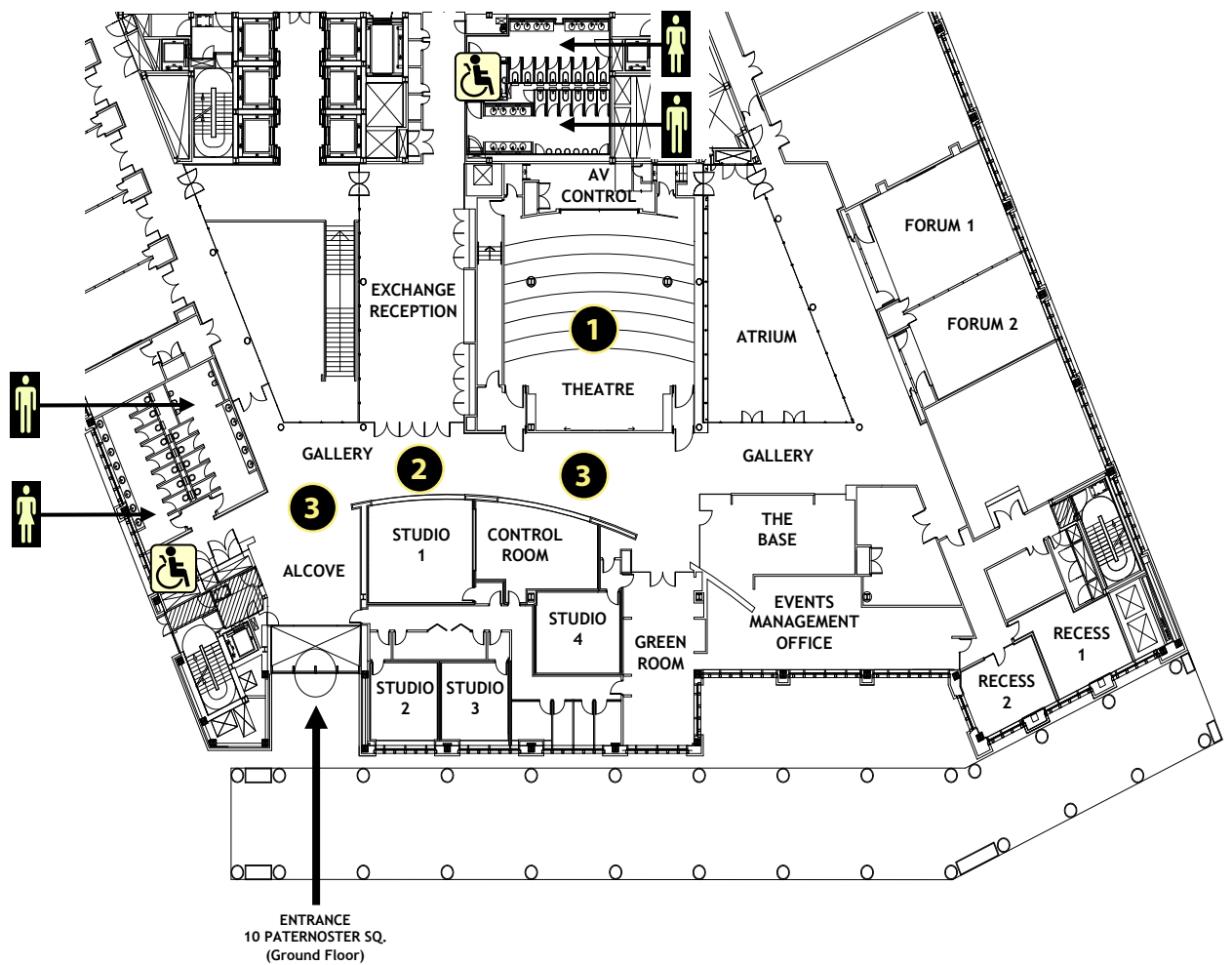

- 1** July 8-9, Master Classes and Conference
- 2** Registration Area
- 3** Exhibition and Catering Area



London
Stock Exchange

Map and directions

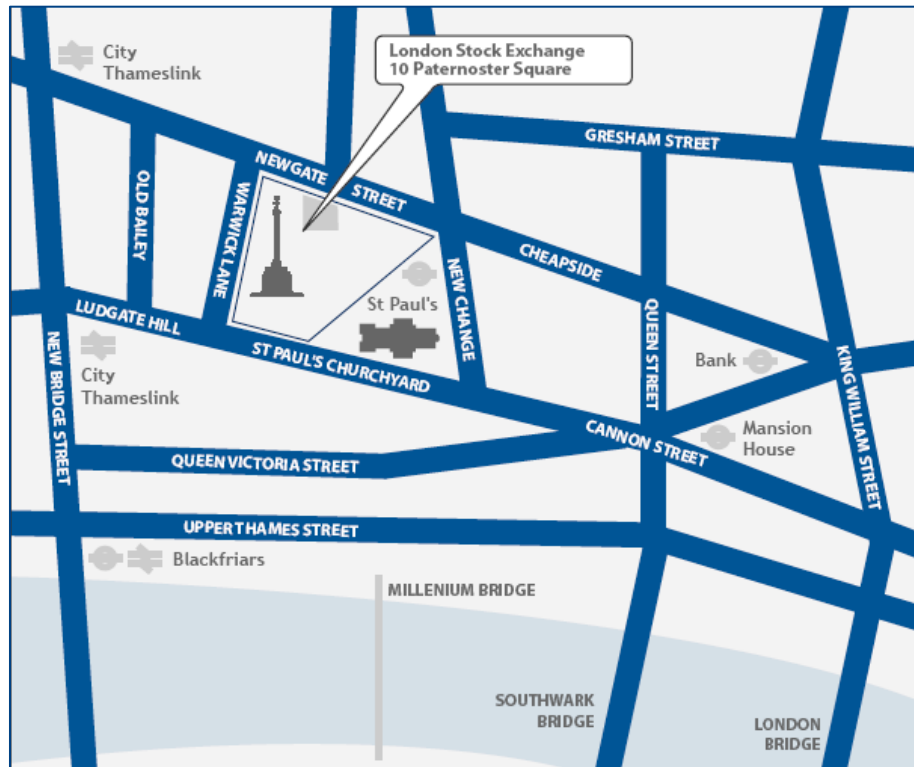

Contact details

London Stock Exchange
10 Paternoster Square
London
EC4M 7LS

Switchboard: +44 (0)20 7797 1000
Events Team: +44 (0)20 7797 2040
Email: events@londonstockexchange.com
www.londonstockexchange.com

Public transport

The London Stock Exchange is easily accessible by public transport. The nearest Underground station is St Paul's on the Central Line (within Zone 1) which is a two minute walk from the Cathedral. Mansion House, Cannon Street and Blackfriars stations on the District and Circle Line and main train lines are a slightly longer walk away.

Parking

There is no parking available at the Exchange, the nearest NCP car parks are in Aldersgate.

Coaches

There are coach drop-off and collection points in St Paul's Churchyard in front of the Cathedral. Groups can then walk through Paternoster Square to number 10. Coach parking is available alongside St Paul's Cathedral.

Hotel recommendations

For overnight accommodation close to the London Stock Exchange (10 Paternoster Square, London, EC4M 7LS) we would suggest the following four hotels.

Club Quarters - St Paul's



Address: 24 Ludgate Hill, London, EC4M 7DR
Valerie Newell - Senior Member
Services Associate
Telephone: 020 7451 5800
E-mail: vnewell@clubquarters.com
Website: www.clubquarters.com
Distance from London
Stock Exchange: 0.1 miles or 3 minutes

The Exchange is a member of Club Quarters, the latest concept for the hotel industry. It is a private, full-service hotels for the exclusive use of guests and employees of member companies. They offer unique, user-friendly services in a club-like setting. As a member, we can secure discounted hotel room rates for our clients. Please mention London Stock Exchange when booking.

Renaissance Chancery Court



Address: 252 High Holborn
London
WC1V 7EN
Telephone: 020 7829 9888
Website: www.marriott.com
Distance from London Stock
Exchange: 0.9 miles or 16 minutes

Voted "one of the top five business hotels in the UK" by Conde Nast Traveller Awards 2003, this five-star hotel is designed for the discerning business traveller. The hotel's stunning facilities include an award-winning day spa and destination restaurant, Pearl, designed by Keith Hobbs of Nobu and Le Cercle fame.

Crowne Plaza - The City



Address: 19 New Bridge Street
London
EC4V 6DB
Telephone: 0870 400 9190
E-mail: loncy.info@ichotelsgroup.com
Website: www.crowneplaza.com
Distance from London
Stock Exchange: 0.4 miles or 8 minutes

The Rookery - Farringdon



Address: 18-21 Charterhouse Square
London
EC1M 6AH
Telephone: 020 7012 3700
E-mail: london@malmaison.com
Website: www.malmaison-london.com
Distance from London
Stock Exchange: 0.5 miles or 9 minutes